

**John Deere STS Mounting Kit**  
**Assembly Instructions**

*This product is required when installing a Maurer STS (9E000001) Bin Extension on the 60 & 70 series STS combines equipped with the High Rate Unloading Auger Option.*

**PARTS LIST**

REF.#	PART #	QTY.	DESCRIPTION
1.	R3E000101P0	2	Mounting Plate - Front & Rear
2.	R3E000102P0	2	Front Mounting Bracket
3.	R3E000103P0	2	Rear Mounting Bracket
4.	1AR00000013	1	Front Plastic Spacer Plate
5.	1AR00000014	1	Rear Plastic Spacer Plate
6.	1AR00000015	1	Right Plastic Spacer Plate
7.	1AR00000016	1	Left Plastic Spacer Plate
8.	1AFC37EAAH5	11	5/16" x 1-1/2 Serrated Flange Bolt
9.	1AFC37E00L0	4	5/16" x 3/4" Serrated Flange Bolt
10.	1AFC08E0000	15	5/16" Serrated Flange Nut
11.	R3E000021P0	3	Frame Spacer

Please order replacement parts by PART NO. and DESCRIPTION.

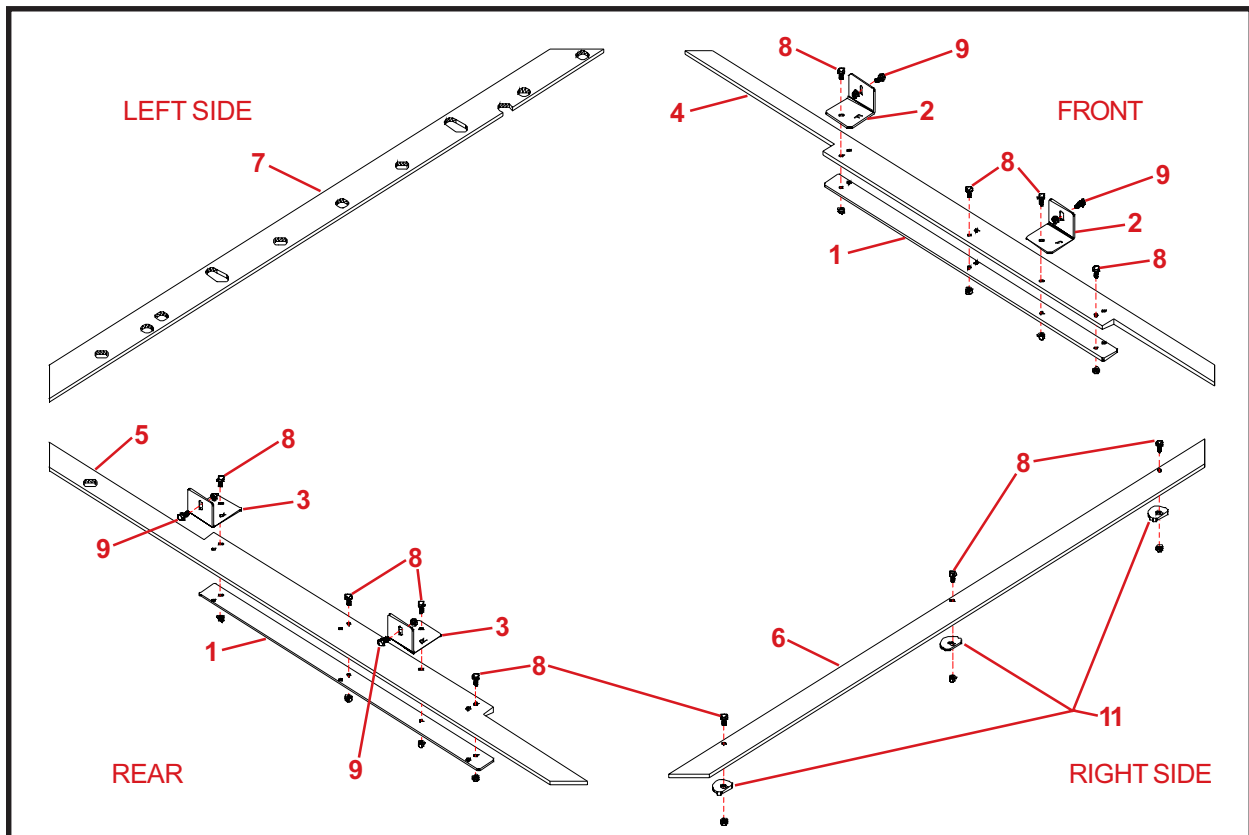

Figure 1

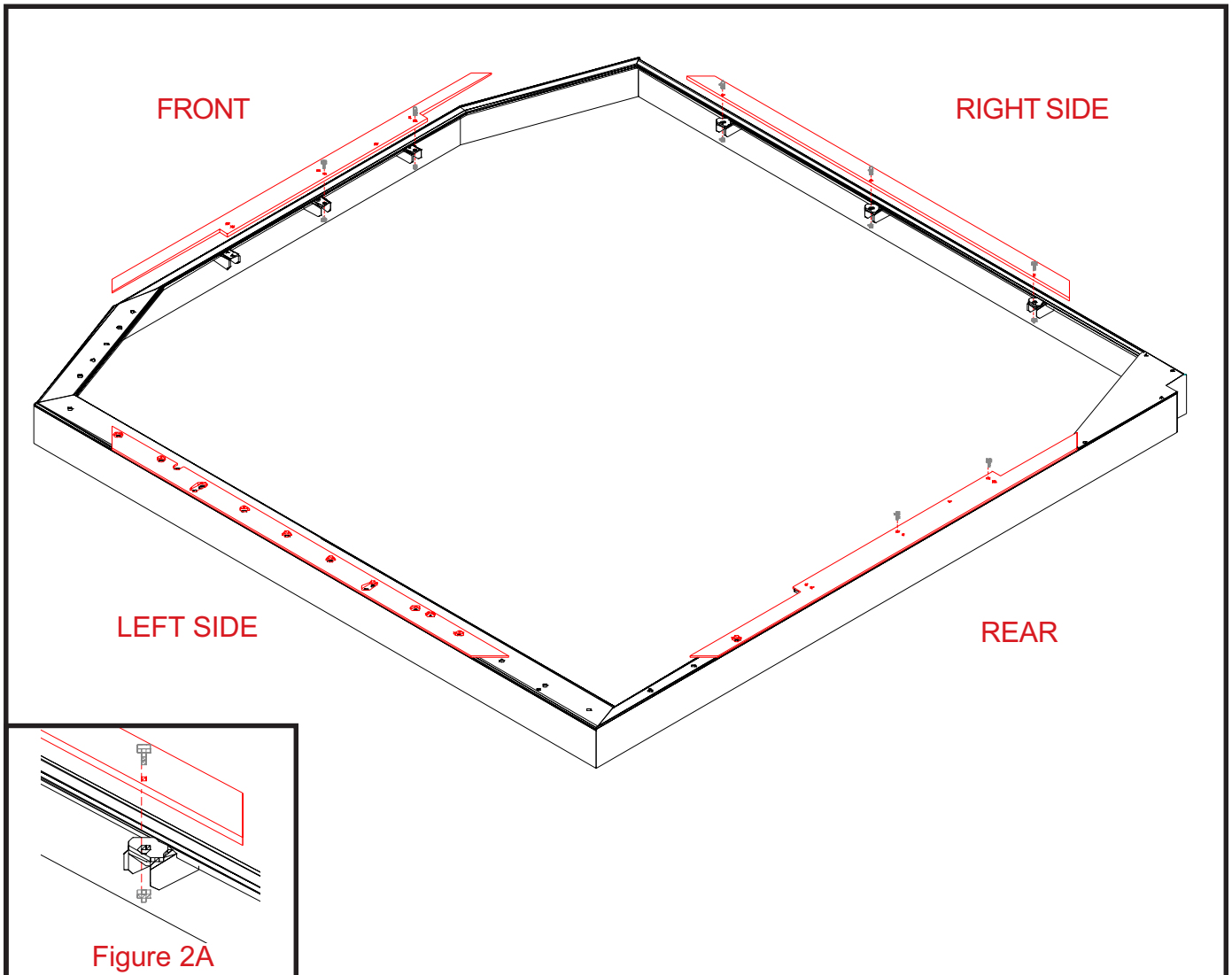

Figure 2

**STEP 1:**

Place front mounting plate on top of the three existing JD brackets located at the front of the combine tank. Align the holes of the front plastic spacer plate with the mounting plate, and existing JD bracket holes. Fasten these parts together with the 5/16" x 1-1/2" serrated flange bolts, and 5/16" serrated flange nuts. See figure 2.

**STEP 2:**

Place rear mounting plate on top of the three existing JD brackets located at the rear of the combine tank. Align the holes of the front plastic spacer plate with the mounting plate, and existing JD bracket holes. Fasten these parts together with the 5/16" x 1-1/2" serrated flange bolts, and 5/16" serrated flange nuts. See figure 2.

**STEP 3:**

Place left plastic spacer plate, over the bolt heads extending above the combine tank on the left side of the tank. Position the plastic spacer plate as shown in figure 2.

**STEP 4:**

Position a frame spacer on each of the three existing JD brackets located on the right side of the combine tank. Align the holes of the right plastic spacer plate with the frame spacer, and the existing JD bracket holes. See figure 2A. Fasten these parts together with 5/16" x 1-1/2" serrated flange bolts, and 5/16" serrated flange nuts.

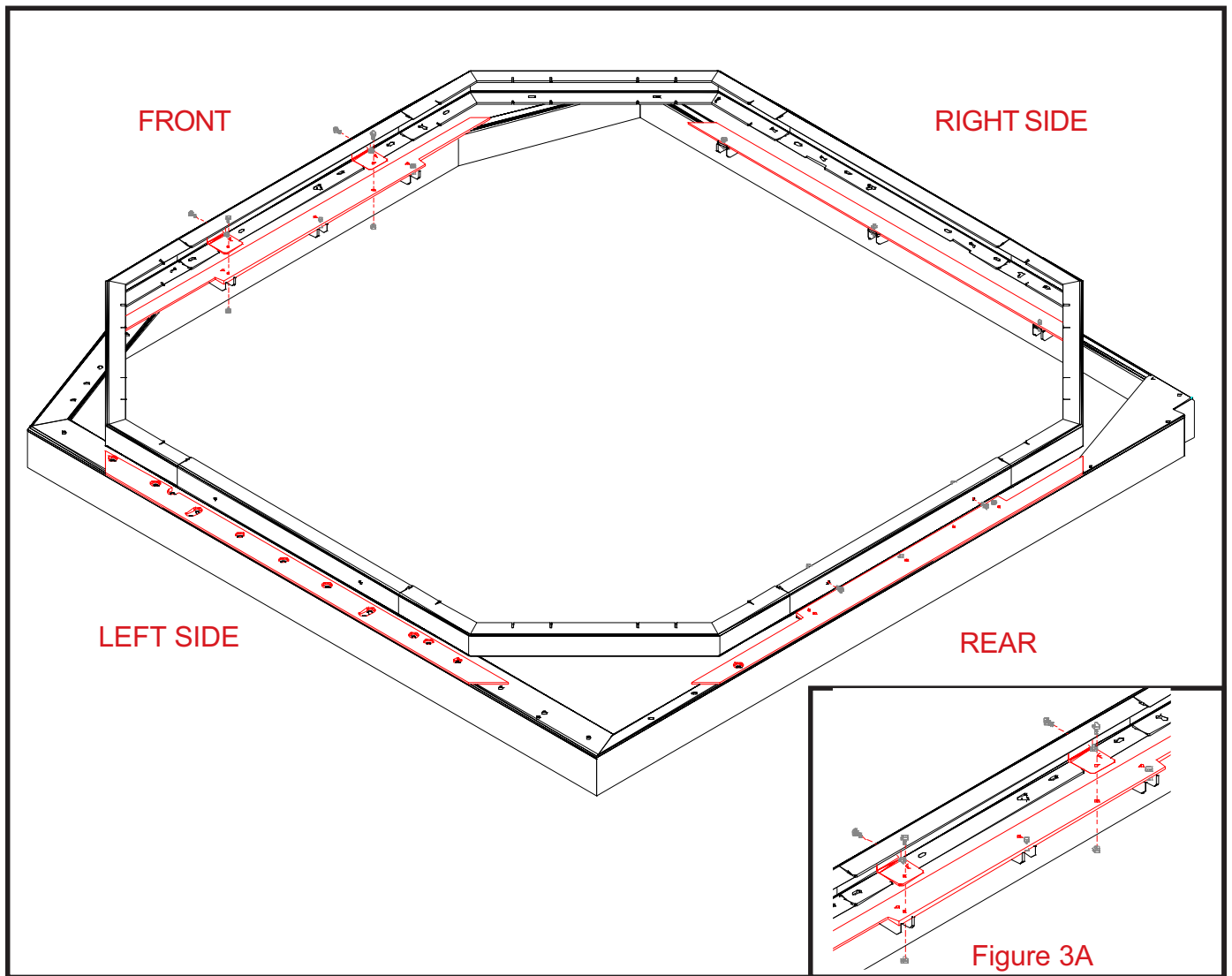

Figure 3

**STEP 5:**

Place the Maurer bin extension frame or complete extension on top of the plastic spacer plates. See figure 3. Fasten the front mounting brackets to the inside of the extension frame using the 5/16" x 3/4" serrated flange bolts and 5/16" serrated flange nuts. Notice that the front mounting bracket is designated with the letter "F".

**STEP 6:**

Fasten the rear mounting brackets to the inside of the extension frame using the 5/16" x 3/4" serrated flange bolts and 5/16" serrated flange nuts. Notice that the rear mounting bracket is designated with the letter "R".

**STEP 7:**

Align the holes of the mounting brackets, with holes in the previously installed plastics spacer plates and mounting plates. Fasten these parts together with 5/16" x 1-1/2" serrated flange bolts and 5/16" serrated flange nuts. See figure 3A. Complete this step in the front and rear of the combine tank.

If you have questions not answered in this instruction sheet, require additional copies, or if your instruction sheet is damaged, please contact your dealer or Maurer Manufacturing, P.O. Box 160, 1300 38th Ave. West, Spencer, Iowa 51301, Ph: (712) 262-2992 Fax: (712) 262-1022 [www.maurermfg.com](http://www.maurermfg.com)

