

Installation Guide

IH 86 - 88 Series Mirror (PN: 3135)

Fits:
IH 86 - 88 Series

NOTE: Mirror can be used on either the right or left side.

1. Place the **mounting bracket** on the cab door post 2 1/2" down from the top corner.
2. Drill three 17/64" holes through the cab post and fasten the **mounting bracket** using three 5/16" x 3/4" self-threading bolts.
3. Fasten the **mirror arm assembly** to the **mounting bracket** with two 5/16" x 1" full thread bolts, flat washers, lock washers and nuts.
4. Insert the **small tube** into the **mirror arm assembly** and secure with the **plastic mirror knob**.

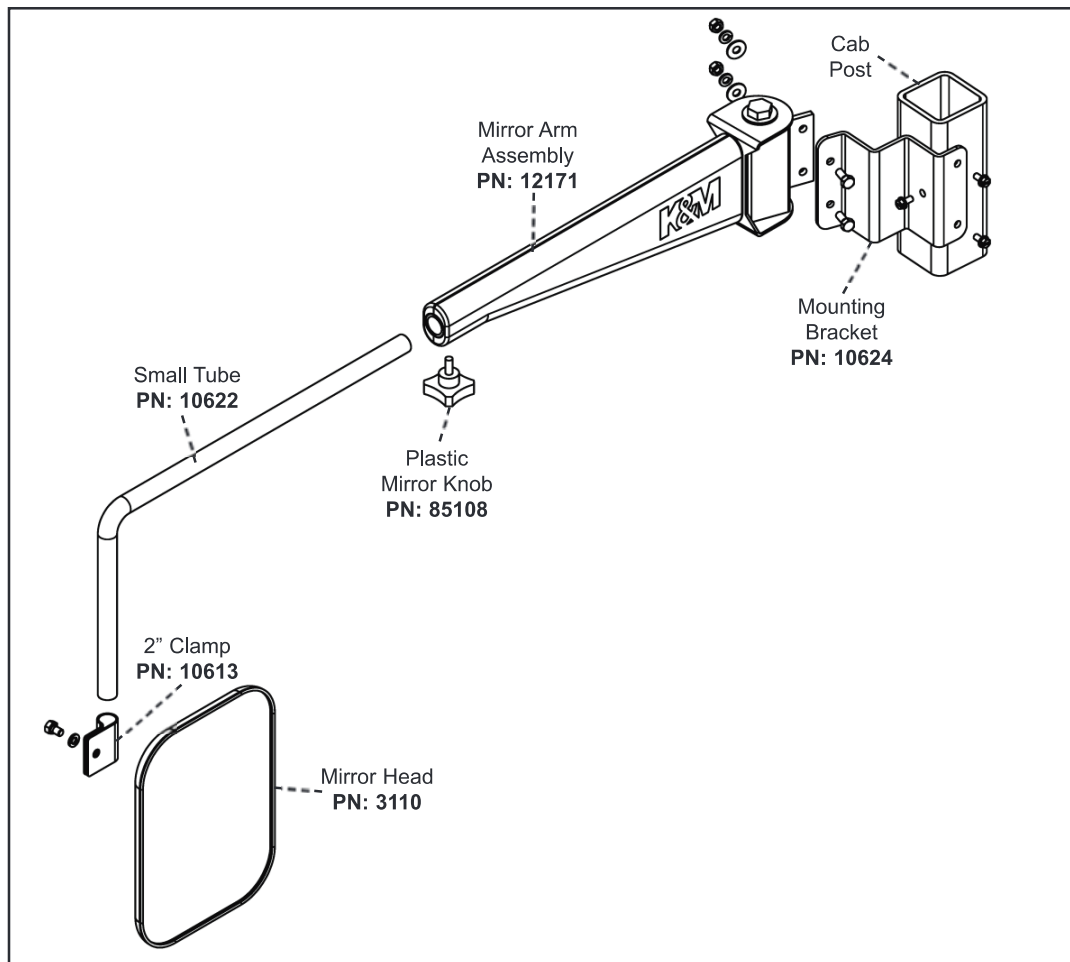

Note!

Do not overtighten the plastic mirror knob.

5. Fasten the **mirror head** to the **small pipe** with the **2" clamp** and included hardware.