

Installation Guide

CIH Magnum 8900 Mirror - Left Side (PN: 3130)

Fits:

CIH Magnum 8900 Series

1. Fasten the **mirror mounting bracket** to the cab mirror bracket with three 8mm x 20mm bolts and lock washers.
2. Fasten the **mirror arm assembly** to the **mounting bracket** with two 5/16" x 1" full thread bolts, flat washers, lock washers and nuts.
3. Insert the **small tube** into the **mirror arm assembly** and secure with the **plastic mirror knob**.
4. Fasten the **mirror head** to the **small pipe** with the **2" clamp** and included hardware.

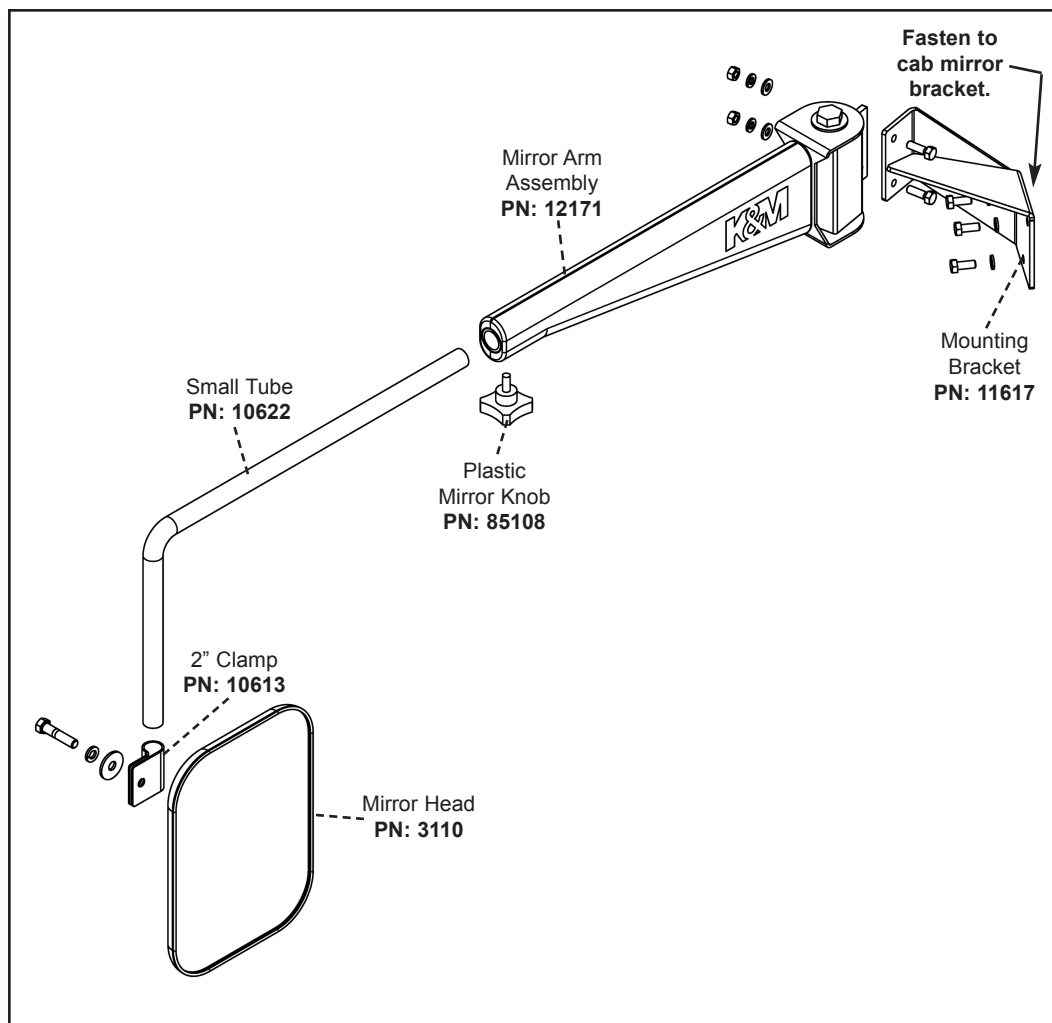

Note!

Do not overtighten the plastic mirror knob in step 3.