

Instruction Guide

John Deere 8000 Series Mirror (PN: 3106)

Also Available:

36" - 50" Mirror Extension Kit - PN: 3122

38" - 62" Extra Long Mirror Extension Kit - PN: 3141

Fits:

8000 & 8010 Series

NOTE: Mirror can be used on either the right or left side.

1. Use the **mounting bracket** as a template and drill two 17/64" holes in the cab frame above the handrail.
2. Fasten the **mounting bracket** with two 5/16" x 3/4" self-threading screws.
3. Attach the **large pipe clamp** to the **mounting bracket** with two 5/16" x 1 1/2" full thread bolts, **inner fastener plate**, **outer plate**, flat washers lock washers and nuts. Tighten only the **inner fastener plate** at this time.

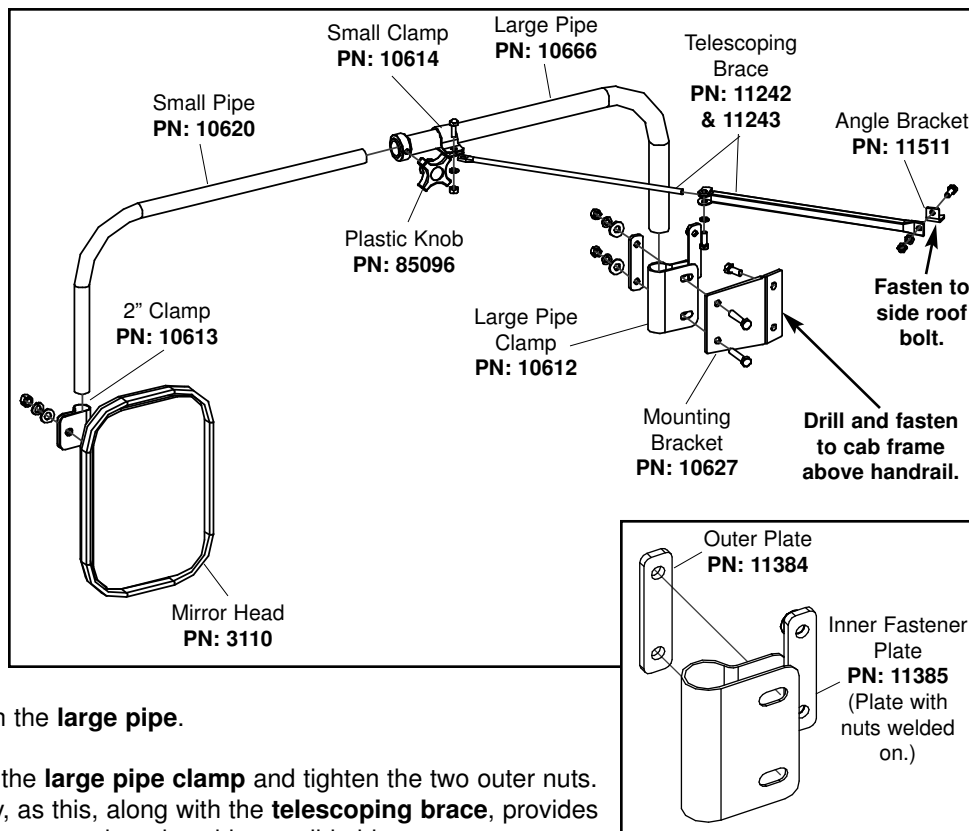

4. Place the **small clamp** on the **large pipe**.
5. Insert the **large pipe** into the **large pipe clamp** and tighten the two outer nuts. Tighten to a firm hold only, as this, along with the **telescoping brace**, provides a break-away feature in the event the mirror hits a solid object.
6. Insert the **small pipe** into the **large pipe** and secure with **plastic knob**.

Note!

Do not over-tighten the plastic knob.

7. Fasten the **mirror head** to the **small pipe** with the **2" clamp**, flat washer, lock washer and nut.
8. Fasten the **small angle bracket** to the side roof bolt. The **telescoping brace** fastens to the **small clamp** on the **large pipe** and to the **angle bracket** with two 1/4" x 3/4" bolts, lock washers and nuts. Also use a 1/4" x 3/4" bolt and lock washer at the center of the **telescoping brace** where the two pieces meet.

NOTE: When using a Mirror Extension Kit, it is recommended that you keep the old extension tube in case it is needed in the future.