

# OWNER'S MANUAL

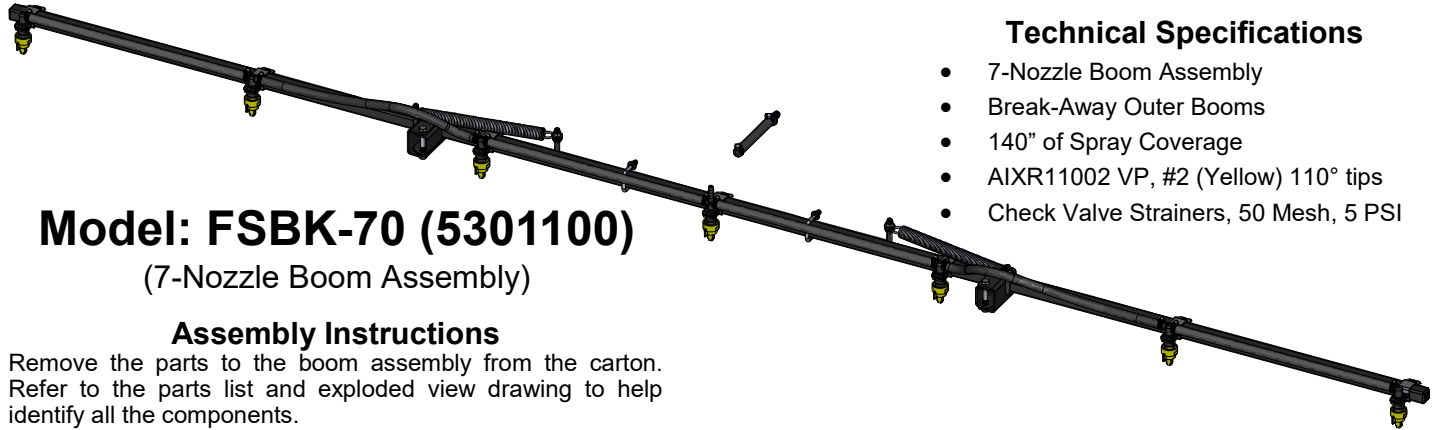

## Model: FSBK-70 (5301100) (7-Nozzle Boom Assembly)

### Assembly Instructions

Remove the parts to the boom assembly from the carton. Refer to the parts list and exploded view drawing to help identify all the components.

- Center the center section of the boom onto your boom mounts and secure in place with the hardware provided. Be sure that the outer booms will fold 'backwards'. The boom should be a minimum of 18" above the ground.

### Technical Specifications

- 7-Nozzle Boom Assembly
- Break-Away Outer Booms
- 140" of Spray Coverage
- AIXR11002 VP, #2 (Yellow) 110° tips
- Check Valve Strainers, 50 Mesh, 5 PSI

- Attach the nozzle harness assembly to the boom. The end boom members should fold towards the rear of the sprayer.
- Route your boom feeder hose (not included) under the unit, to the back end of the sprayer. Join the hose to the 'cross fitting'. Then clamp in place with a hose clamp.

**CAUTION:** Never use a metal object or other sharp item for cleaning a nozzle tip. It is better to use a nozzle brush (NOT wire brush) or compressed air for tip cleaning.

IF YOU SHOULD HAVE A QUESTION OR EXPERIENCE A PROBLEM WITH YOUR AG SPRAY PRODUCT GIVE US A CALL

<b>BAKERSFIELD, CA</b> 877-724-2236	<b>COLUMBUS, NE</b> 800-274-1025	<b>DOTHAN, AL</b> 800-227-4098
<b>FARGO, ND</b> 701-280-2862	<b>HOPKINSVILLE, KY</b> 800-637-7172	<b>MANKATO, MN</b> 507-388-6295
<b>NEWTON, KS</b> 800-394-7662	<b>PASCO, WA</b> 800-634-2026	<b>TEMPE, AZ</b> 877-974-7166

**BEFORE YOU CALL, PLEASE HAVE THE FOLLOWING INFORMATION AVAILABLE: SALES RECEIPT & MODEL NUMBER. IN MOST CASES, AN AG SPRAY EMPLOYEE CAN RESOLVE THE PROBLEM OVER THE PHONE**

### General Information

Thank you for purchasing this product. The purpose of this manual is to assist you in operating and maintaining your boom kit.



**WARNING:** To reduce the risk of injury, the user must read and understand the operator's manual before using this product.



**WARNING:** Cancer and Reproductive Harm  
[www.P65Warnings.ca.gov](http://www.P65Warnings.ca.gov)

**Retain a copy of your receipt for your unit, as it will be required to validate any warranty service. Products are warranted against manufacturer or workmanship defects for one year from date of purchase for home owner usage and 90 days for commercial usage.**

For technical assistance, visit our website @ [www.agspray.com](http://www.agspray.com) or call: Toll Free to one of the above phone numbers. Our Technical Support Representatives will be happy to help you. To obtain prompt, efficient service, always remember to give the following information...

- Correct Part Description and/or part number
  - Model #/Serial # of your sprayer

Part descriptions and numbers can be obtained from the illustrated parts list section(s) of this manual.

Spray Tip Rate Chart (20" Spacing)

Tip No.	Pressure (psi)	Capacity (GPM)	Gallons Per Acre - Based on Water							
			1 MPH	2 MPH	3 MPH	4 MPH	5 MPH	6 MPH	8 MPH	
AIXR11002VP	15	.12	35.6	17.8	11.8	8.9	7.1	5.9	4.5	
	20	.14	41.6	20.8	13.8	10.4	8.3	6.9	5.2	
	30	.17	50.4	25.2	16.8	12.6	10.1	8.4	6.3	
	40	.20	59.6	29.8	19.8	14.9	11.9	9.9	7.4	
Tip No.	Pressure (psi)	Capacity (GPM)	Gallons Per 1000 Sq. Ft. - Based on Water							
			1 MPH	2 MPH	3 MPH	4 MPH	5 MPH	6 MPH	8 MPH	
AIXR11002VP	15	.12		.41	.27	.20	.16			
	20	.14		.48	.32	.24	.19			
	30	.17		.58	.39	.29	.23			
	40	.20		.68	.45	.34	.27			

110° wide, tapered flat spray angle with air induction technology for better drift management. Made of 2-piece UHMWPE polymer construction which provides excellent chemical resistance, including acids, as well as exceptional wear life. Compact size to prevent tip damage. Removable pre-orifice. Excellent for systemic products and drift management.



[www.agspray.com](http://www.agspray.com)

[5004522

(11/18)]

## Testing the Sprayer

**NOTE:** It is VERY important for to test your sprayer with plain water before actual spraying is attempted. This will enable you to check for leaks without the possibility of losing any expensive chemicals.

## Operation

Always fill the tank 1/2 full with water first and then add the chemical slowly, mixing as you pour the chemical into the tank and then fill the rest of the way. You may use your handgun or the bypass line in order to mix the chemical and water.

Initially begin spraying by opening the handgun/boom. This will enable the air in the line to be purged through the handgun tip/boom tip, while building pressure.

## Adjusting Pressure

- When the bypass valve is closed, pressure is at the highest point.
- Opening the valve will decrease pressure.

Conditions of weather and terrain must be considered when setting the sprayer. Do not spray on windy days. Protective clothing must be worn in some cases

**Be sure to read the chemical label(s) before application!**

## Calibration

Chemical labels may show application rates in gallons per acre, gallons per 1000 square feet or gallons per 100 square feet. You will note that the tip chart shows 2 of these rating systems.

Once you know how much you are going to spray, then determine (from the tip chart) the spraying pressure (PSI), and the spraying speed (MPH).

Determining the proper speed of the pulling vehicle can be done by marking off 100, 200 & 300 feet. The speed chart indicates the number of seconds it takes to travel the distances. Set the throttle and with a running start, travel the distances. Adjust the throttle until you travel the distances in the number of seconds indicated by the speed chart. Once you have reached the throttle setting needed, mark the throttle location so you can stop and go again, returning to the same speed. After testing, add water and proper amount of chemical to the tank and drive to the starting place for spraying. Adjust the pressure and spray as you did in the testing procedure.

## Using the Boom Nozzle

Four things must be considered before spraying with the boom.

1. How much chemical must be mixed in the tank.
  2. Rate of spray (gallons per acre to be sprayed).
  3. What pressure (p.s.i.) will be used.
  4. Speed traveled (mph) while spraying.
- \* Refer to the chemical label to determine your chemical mixture
  - \* See the tip chart to determine the pressure to be used. The chart will also show the speed used when spraying.
  - \* Start the pump and open the valve to the boom nozzles.
  - \* Check the spray pattern. Usually you can see the coverage better on a solid concrete surface, such as a driveway.

## Maintenance During/After Spraying

Periodically check the strainer and clean the screen on your intake line. Proper care and maintenance will prolong the life of your sprayer.

After use, fill the sprayer half way with clean water. Start the pump and allow the water to pump through the entire plumbing system and nozzles. Drain and then refill half full, add the recommended amount of a good quality tank cleaner, such as FIMCO Tank Neutralizer and Cleaner. (If no tank cleaner is available, you may substitute dish soap for this step). Turn pump on and circulate through system for 15 minutes and then spray out through boom and handgun nozzles. Refill sprayer half way with clean water and repeat. Follow the chemical manufacturer's disposal instructions of all wash or rinsing water.

If boom nozzle needs cleaning, remove them from the sprayer and soak in warm soapy water. Clean with a soft bristled brush or toothpick if necessary. Never use a metal object. Even the slightest damage can change the flow rate and spray distribution. Water rinse and dry before storing.

**WARNING: Some chemicals will damage the pump valves if allowed to soak untreated for a length of time! ALWAYS flush the pump as instructed after each use. DO NOT allow chemicals to sit in the pump for extended times of idleness. Follow the chemical manufacturer's instructions on disposal of all waste water from the sprayer.**

## Winter Storage

Before storing your sprayer for winter or long term storage, thoroughly clean and drain it as much as possible. Then pour enough pink RV antifreeze into the tank so that when the pump is turned on you can pump the antifreeze throughout the entire plumbing system, including the bypass. Make sure to operate the boom and handgun until you see pink fluid spraying from the nozzles. Leave any remaining antifreeze in the tank. Before your next usage, rinse the antifreeze from the sprayer with clean water.

It is nearly impossible to drain all of the water from the sprayer and any trapped water can freeze in cold weather and damage parts of the sprayer. Pumping the antifreeze through the system will displace the water and help prevent this damage

Proper care and maintenance will prolong the life of your sprayer.

Speed Chart			
	Time Required in seconds to travel a distance of		
Speed in M.P.H. (Miles Per Hour)	100 Ft.	200 Ft.	300 Ft.
1.0	68 sec.	136 sec.	205 sec.
2.0	34	68	102
3.0	23	45	68
4.0	17	34	51
5.0	14	27	41
6.0	11	23	34
7.0	9.7	19	29
8.0	8.5	17	26
9.0	7.6	15	23
10.0	6.8	14	20

Based on the minimum overlap required to obtain uniform distribution with 110° tips and 20" spacing.

Suggested Minimum Spray Height: 16"-18" above what is being sprayed (to plant, not ground).

Optimum Spray Height: 20"

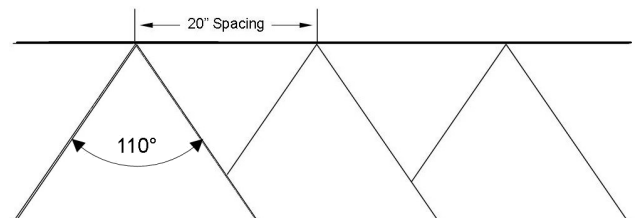

# Exploded View/Parts List: FSBK-70 (5301100)

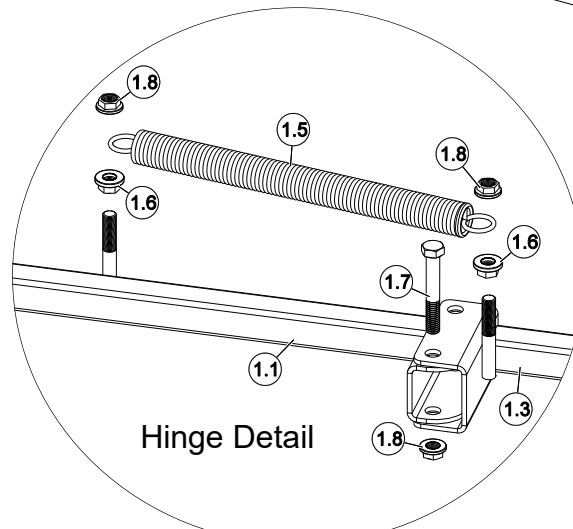
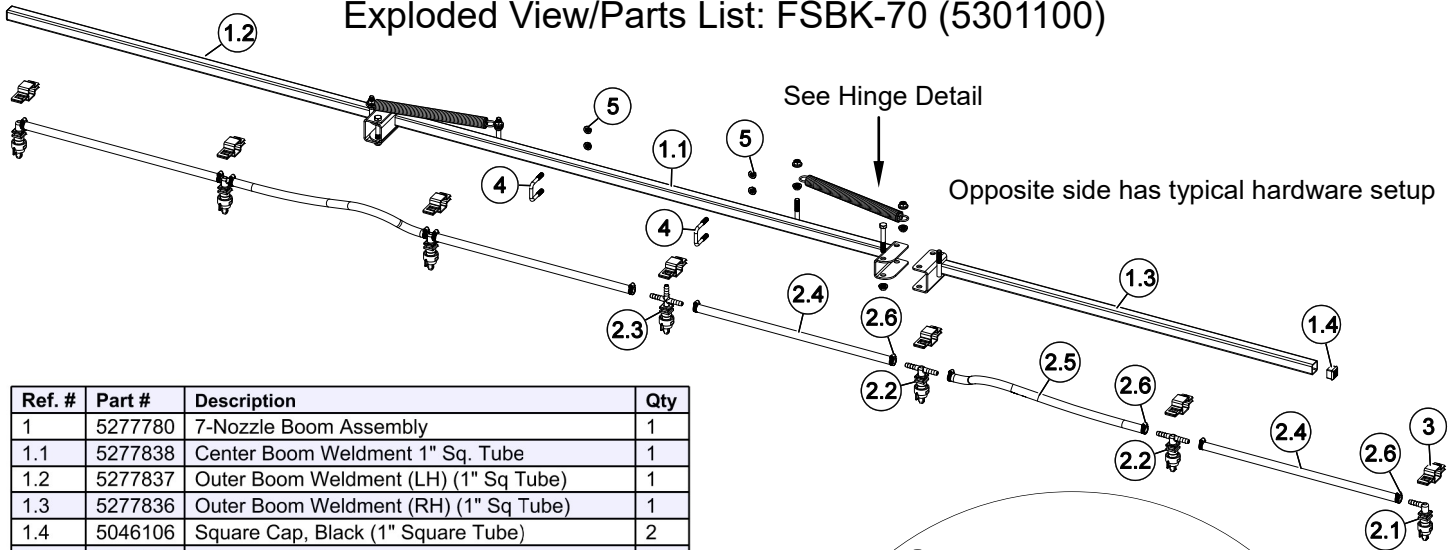

Ref. #	Part #	Description	Qty
1	5277780	7-Nozzle Boom Assembly	1
1.1	5277838	Center Boom Weldment 1" Sq. Tube	1
1.2	5277837	Outer Boom Weldment (LH) (1" Sq Tube)	1
1.3	5277836	Outer Boom Weldment (RH) (1" Sq Tube)	1
1.4	5046106	Square Cap, Black (1" Square Tube)	2
1.5	5019228	Extension Spring	2
1.6	5006259	3/8"-16 Hex Whiz (Flange) Locknut	4
1.7	5034169	H.H.C.S., 3/8"-16 x 2 1/2"	2
1.8	5006345	3/8"-16 Flange Locknut (Grade F)	6
2	5277696	7-Nozzle Harness (3/8")	1
2.1	5281304	"ELL" Nozzle Sub-Assembly (3/8")	2
2.1.1	5056113	Single Hose Shank (3/8" Hose)	1
2.1.2	5143543	Check Valve Strainer, 50 Mesh, 5 PSI	1
2.1.3	5016157	Seat Washer (QJ Caps)	1
2.1.4	5018371	Air-Induction XR Flat Spray Tip (AIXR11002VP)	1
2.1.5	5046219	Quick TeeJet Cap ONLY (Yellow)	1
2.2	5281307	"TEE" Nozzle Sub-Assembly (3/8")	4
2.2.1	5056114	Double Hose Shank (3/8" Hose)	1
2.2.2	5143543	Check Valve Strainer, 50 Mesh, 5 PSI	1
2.2.3	5016157	Seat Washer (QJ Caps)	1
2.2.4	5018371	Air-Induction XR Flat Spray Tip (AIXR11002VP)	1
2.2.5	5046219	Quick TeeJet Cap ONLY (Yellow)	1
2.3	5281308	"Cross" Nozzle Sub-Assembly (3/8")	1
2.3.1	5056115	Triple Hose Shank (3/8" Hose)	1
2.3.2	5143543	Check Valve Strainer, 50 Mesh, 5 PSI	1
2.3.3	5016157	Seat Washer (QJ Caps)	1
2.3.4	5018371	Air-Induction XR Flat Spray Tip (AIXR11002VP)	1
2.3.5	5046219	Quick TeeJet Cap ONLY (Yellow)	1
2.4	5020510	Hose, 3/8"-1 Brd. x 19-3/8"	4
2.5	5020347	Hose, 3/8"-1 Brd. x 21"	2
2.6	5051144	Hose Clamp, 3/8"	12
3	5277923	Boom Clamp Assembly (1in Sq.)	7
4	5034159	Square U-Bolt, 5/16" x 1 5/16" x 1 7/8"	2
5	5006307	5/16"-18 Hex Whiz (Flange) Locknut	4
6	5277926	1/2" Hose to 3/8" Hose Conversion Kit	1
6.1	5067228	1/2" x 3/8" Poly Hose Mender	1
6.2	5020417	Hose, 3/8"-1 Brd. x 5-1/2"	1
6.3	5051144	Hose Clamp, 3/8"	2

Hinge Detail

Nozzle Assembly

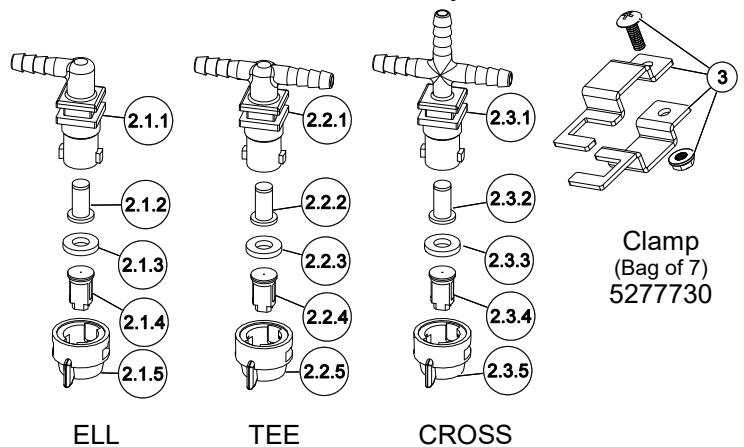

ELL

TEE

CROSS

## #5277926

### 1/2" to 3/8" Conversion Kit

If your existing sprayer has a 1/2" I.D. hose supplying your original boom and you now have a boom with 3/8" I.D. hose, this conversion kit allows you to easily convert your supply line to fit onto the 3/8" I.D. hose of your new boom.

Slip the hose mender's 1/2" barb (larger side) into your existing 1/2" feeder hose and clamp in place with (existing) original hose clamp. Slip the (included) 3/8" hose (5-1/2" long) onto the 3/8" barb of the hose mender and clamp in place with one of the supplied hose clamps.

Now attach the open end of the hose onto the fitting on your boom which accepts the feeder line hose. Make sure you place the hose clamp onto that hose prior to attaching it to your boom.

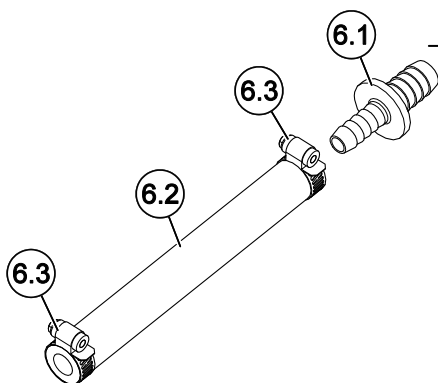

# Warranty

## LIMITED WARRANTY FOR NEW AG SPRAY EQUIPMENT

**WHO MAY USE THIS LIMITED WARRANTY.** This limited warranty (the "Limited Warranty") is provided by Ag Spray Equipment to the original purchaser ("you") of the Equipment (as defined below) from Ag Spray Equipment or one of Ag Spray Equipment's authorized dealers. This Limited Warranty does not apply to any subsequent owner or other transferee of the Equipment. THIS LIMITED WARRANTY GIVES YOU SPECIFIC LEGAL RIGHTS, AND YOU MAY ALSO HAVE OTHER RIGHTS WHICH VARY FROM STATE TO STATE.

**WHAT THIS LIMITED WARRANTY COVERS AND FOR HOW LONG.** Ag Spray Equipment warrants that any new Equipment will be free from defects in material and workmanship for a period of **one (1) year** after delivery of the Equipment to you (the "Warranty Period"). The Warranty Period is not extended if Ag Spray Equipment repairs or replaces the Equipment.

**WHAT IS NOT COVERED BY THIS LIMITED WARRANTY.** This Limited Warranty does not apply to: (1) used Equipment; (2) any Equipment that has been altered, changed, repaired or treated since its delivery to you, other than by Ag Spray Equipment or its authorized dealers; (3) damage or depreciation due to normal wear and tear; (4) defects or damage due to failure to follow Ag Spray Equipment's operator's manual, specifications or other written instructions, or improper storage, operation, maintenance, application or installation of parts; (5) defects or damage due to misuse, accident or neglect, "acts of God" or other events beyond Ag Spray Equipment's reasonable control; (6) accessories, attachments, tools or parts that were not manufactured by Ag Spray Equipment, whether or not sold or operated with the Equipment; or (7) rubber parts, such as tires, hoses and grommets.

**HOW TO OBTAIN WARRANTY SERVICE.** To obtain warranty service under this Limited Warranty, you must (1) provide written notice to Ag Spray Equipment of the defect during the Warranty Period and within **thirty (30)** days after the defect becomes apparent or the repair becomes necessary, at the following address: Ag Spray Equipment, 1000 Fimco Lane, North Sioux City, SD 57049; and (2) make the Equipment available to Ag Spray Equipment or an authorized dealer within a reasonable period of time. For more information about this Limited Warranty, please call: **800-274-1025** or your local Ag Spray location.

**WHAT REMEDIES ARE AVAILABLE UNDER THIS LIMITED WARRANTY.** If the conditions set forth above are fulfilled and the Equipment or any part thereof is found to be defective, Ag Spray Equipment shall, at its own cost, and at its option, either repair or replace the defective Equipment or part. Ag Spray Equipment will pay for shipping and handling fees to return the repaired or replacement Equipment or part to you.

**LIMITATION OF IMPLIED WARRANTIES AND OTHER REMEDIES.** THE REMEDIES DESCRIBED ABOVE ARE YOUR SOLE AND EXCLUSIVE REMEDIES, AND AG SPRAY EQUIPMENT'S SOLE LIABILITY, FOR ANY BREACH OF THIS LIMITED WARRANTY. TO THE EXTENT APPLICABLE, ANY IMPLIED WARRANTIES, INCLUDING, WITHOUT LIMITATION, THE IMPLIED WARRANTIES OF MERCHANTABILITY AND FITNESS FOR A PARTICULAR PURPOSE, SHALL BE LIMITED IN DURATION TO THE WARRANTY PERIOD, AND THE REMEDIES AVAILABLE FOR BREACH THEREOF SHALL BE LIMITED TO THE REMEDIES AVAILABLE UNDER THIS EXPRESS LIMITED WARRANTY. SOME STATES DO NOT ALLOW LIMITATIONS ON HOW LONG AN IMPLIED WARRANTY LASTS, SO THE ABOVE LIMITATION MAY NOT APPLY TO YOU. IN NO EVENT SHALL AG SPRAY EQUIPMENT'S LIABILITY UNDER THIS LIMITED WARRANTY EXCEED THE ACTUAL AMOUNT PAID BY YOU FOR THE DEFECTIVE EQUIPMENT, NOR SHALL AG SPRAY EQUIPMENT BE LIABLE, UNDER ANY CIRCUMSTANCES, FOR ANY CONSEQUENTIAL, INCIDENTAL, SPECIAL OR PUNITIVE DAMAGES OR LOSSES, WHETHER DIRECT OR INDIRECT. SOME STATES DO NOT ALLOW THE EXCLUSION OR LIMITATION OF INCIDENTAL OR CONSEQUENTIAL DAMAGES, SO THE ABOVE LIMITATION OR EXCLUSION MAY NOT APPLY TO YOU.