

# Instruction Guide

**JD Combine Mud Scraper (PN: 1202)**

*Fits:*  
**JD 9000 Walker Series Combines**

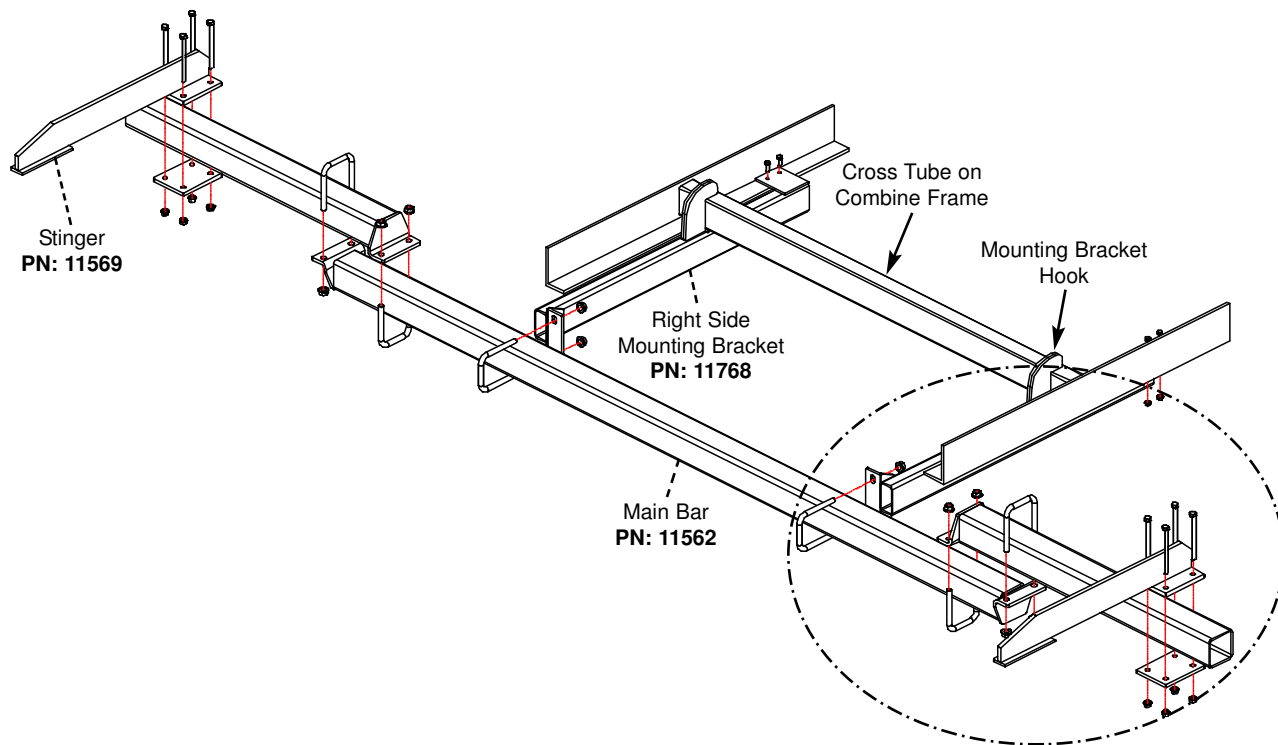

1. Slip the hook of the **mounting bracket** over the cross tube of the combine frame and fasten to the existing hole with a 3/8" x 1" bolt and flange nut on each side.
2. Drill the second hole on each side of the mounting brackets and attach with 3/8" x 1" bolts and flange nuts.
3. Mount the **main bar** to the **mounting brackets** and fasten with two 4" U-bolts and flange nuts.
4. Place the **extension bars** on top of the **main bar** and secure with four 4" U-bolts and flange nuts. Adjust to match wheel spacings.
5. Attach the **stingers** to the **extension bars** and fasten with the **stinger backup plate**, eight 1/2" x 6" bolts and flange nuts.

