



## INSTALLATION INSTRUCTIONS

**PIONEER**

**8700 CASE/I.H. I.S.O. CONVERSION KIT**

**8909-009 Revision: B**



### WARNING

FAILURE OR IMPROPER SELECTION OR IMPROPER USE OF THE PRODUCTS AND/OR SYSTEMS DESCRIBED HEREIN OR RELATED ITEMS CAN CAUSE DEATH, PERSONAL INJURY AND PROPERTY DAMAGE.

- This document and other information from Parker-Hannifin Corporation, its subsidiaries and authorized distributors provide product or system options for further investigation by users having technical expertise.
- The user, through its own analysis and testing, is solely responsible for making the final selection of the system and components and assuring that all performance, endurance, maintenance, safety and warning requirements of the application are met. The user must analyze all aspects of the application, follow applicable industry standards, and follow the information concerning the product in the current product catalog and in any other materials provided from Parker or its subsidiaries or authorized distributors.
- To the extent that Parker or its subsidiaries or authorized distributors provide component or system options based upon data or specifications provided by the user, the user is responsible for determining that such data and specifications are suitable and sufficient for all applications and reasonably foreseeable uses of the components or systems.

The products described herein, including without limitation, product features, specifications, designs, availability and pricing, are subject to change by Parker-Hannifin Corporation and its subsidiaries at any time without notice.

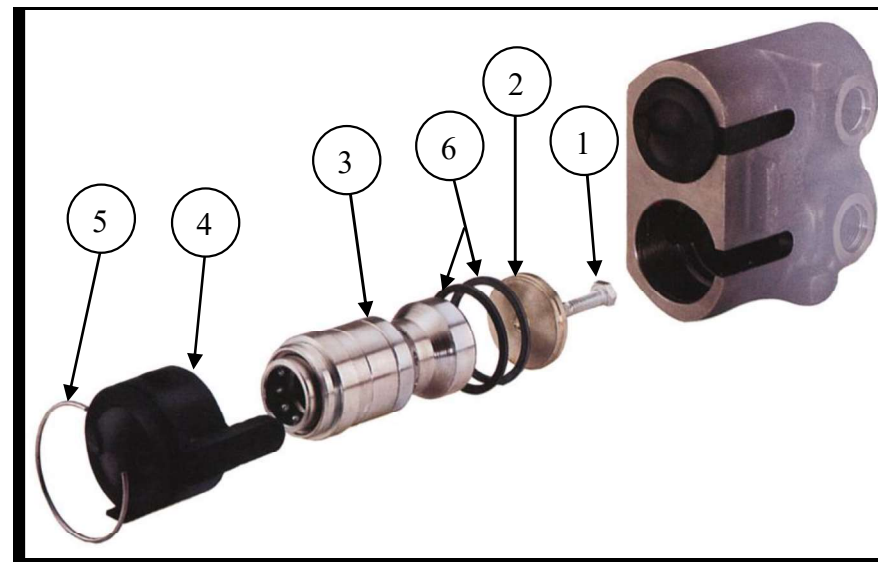

### KIT CONTENTS:

### QUANTITY

#### Item #

1 – CAP SCREW	2
2 – WASHERS	2
3 – CARTRIDGE BODY ASSEMBLY	2
4 – DUST CAP	2
5 – SNAP RING	2
6 – SQUARE CUT SEALS	4
6(b) – O-RING SEALS	4



Parker Hannifin Corporation  
**Pioneer Products Group**  
8145 Lewis Road  
Minneapolis, MN 55427 USA  
Phone: (763)544-7781  
Fax: (763)544-3418  
[www.parker.com/quickcouplings](http://www.parker.com/quickcouplings)

## ***Pioneer***

### ***8700 CASE/I.H. I.S.O. CONVERSION KIT***

---

#### ***REMOVAL OF LEVER CARTRIDGES***

1. Shut tractor down before attempting to disassemble couplers.
2. Actuate the control valve in tractor to relieve trapped pressure.
3. Remove the lever casting assembly by disconnecting the hydraulic tubes at the fittings and removing two cap screws.
4. Remove the female lever cartridges from the casting assembly by removing the retainer rings.
5. If necessary, remove the seals from the inside diameter grooves in the casting. It is possible that a (plastic) slipper seal and an o-ring is used or only an o-ring. Remove all seals that are in the casting grooves which sealed the cartridges that were removed.
6. Retain only the casting assembly.

## ***Pioneer***

### ***8700 CASE/I.H. I.S.O. CONVERSION KIT***

---

#### ***INSTALLATION OF PIONEER CARTRIDGES:***

1. Lubricate square cut seals and install in grooves in casting assembly if a plastic slipper seal and an o-ring was removed from the casting. If only an o-ring was removed, then install the o-rings in to the casting. Left over o-rings or square cut seals will not be used.
2. Install female cartridges.
3. Install washers and cap screws. Torque to 18-20 ft-lbs. (25-27 Nm).
4. Select a location in which a dust cap will be located to determine the "bottom" side of that particular dust cap.
5. Use a sharp knife to cut a 1/8" deep "V" shape groove from the "bottom" drain hole in the dust cap to its rear surface. This groove provides drainage of hydraulic fluid which is lost during uncoupling. If not drained away, the accumulation could cause difficulty during coupling.

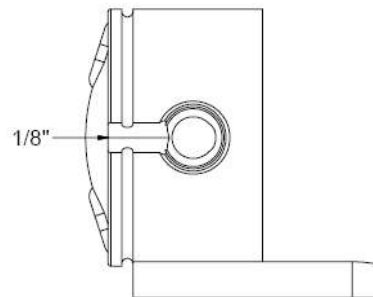

6. Lightly lubricate the dust cap and install in casting assembly with drain groove to the bottom.
7. Install snap rings to retain dust caps. The gap in the snap ring must bridge the drain grooves.
8. Re-assemble casting assembly to tractor.